

## **SECTION 9**

Monoblock and short valves  
Full bore

**BROEN**  
BALLOMAX®

*Designed to last*

# Monoblock and short valve - DN 15 - 32, PN 40/25/16

## Type 94103 - Full bore

### Monoblok single - Wafer type

Fully welded steel ball valve.

### Materials

See next page.

### Applications

Isolating valve for heating systems, district heating, cooling and industrial purpose.

### Media

Water and other media not decomposing the steel. If in doubt, please contact BROEN BALLOMAX® Sales Department.

### Surface treatment

Eco-friendly protection finish against corrosion.

### Operation

The standard handle is 180 degrees adjustable.

### Approvals and certificates

BROEN is certified according to ISO 9001 and environmentally certified according to ISO 14001. BROEN BALLOMAX® is approved according to the requirements of Pressure Equipment Directive (PED). All ball valves as from DN 40 are CE-marked. The 3.1 certificate is available upon request.

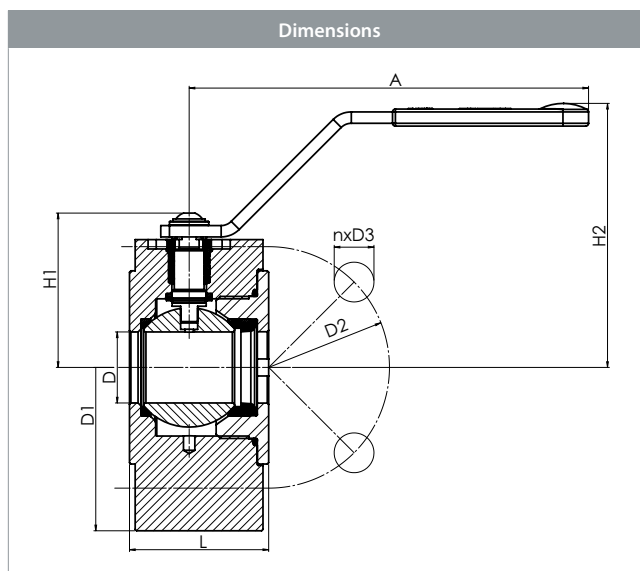

DN	BROEN No.	D = Bore	Kvs	net Weight kg	All dimensions in mm							D3	n
					L	D1	D2	A	H1	H2			
15	9410340015WZ	15	32	1.8	40	95	65	140	46	85		14	4
20	9410340020WZ	20	57	2.8	46	105	75	140	50	88		14	4
25	9410340025WZ	25	81	3.2	49	115	85	140	54	93		14	4
32	9410340032WZ	32	133	5.5	62	140	100	167	71	109		18	4

# Monoblock and short valve - DN 15 - 32, PN 40/25/16

Type 94103 - Full bore



Technical drawing		Material description	
	1	Ball	Steel - SA351Gr CF8
	2	Valve body	Steel - S355J2C
	3	Seat ring	PTFE 20% Carbon
	4	Back-up ring	PTFE 20% Carbon
	5	O-ring	EPDM
	6	O-ring	FKM (Viton)
	7	Handle	Steel

# Monoblock and short valve - DN 15 - 32, PN 40/25/16

## Type 94103 - Full bore

### Monoblok single - Wafer type with ISO-flange

Fully welded steel ball valve.

### Materials

See next page.

### Applications

Isolating valve for heating systems, district heating, cooling and industrial purpose.

### Media

Water and other media not decomposing the steel. If in doubt, please contact BROEN BALLOMAX® Sales Department.

### Surface treatment

Eco-friendly protection finish against corrosion.

### Operation

The standard handle is 180 degrees adjustable.

### Approvals and certificates

BROEN is certified according to ISO 9001 and environmentally certified according to ISO 14001. BROEN BALLOMAX® is approved according to the requirements of Pressure Equipment Directive (PED). All ball valves as from DN 40 are CE-marked. The 3.1 certificate is available upon request.

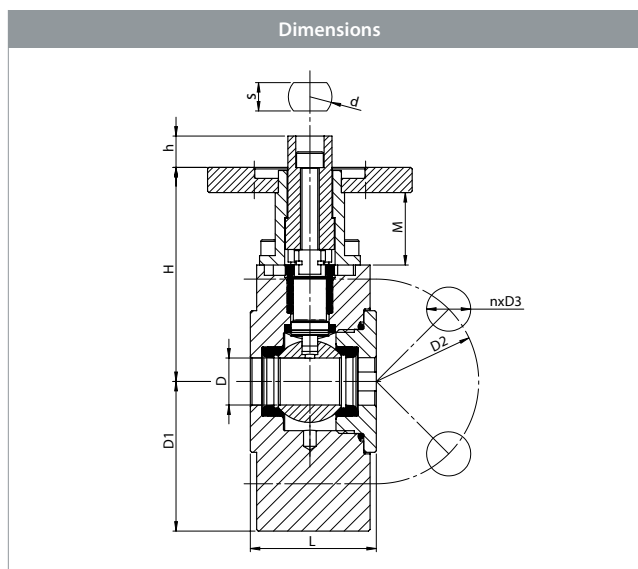

					All dimensions in mm									
DN	BROEN No.	D = Bore	Kvs	net Weight kg	L	D1	D2	d/s	h	H	M	D3	n	ISO
15	9410340015WZ 90	15	32	1.9	40	95	65	14/10	10	68	23	14	4	F5
20	9410340020WZ 90	20	57	2.6	46	105	75	14/10	10	71	23	14	4	F5
25	9410340025WZ 90	25	81	3.3	49	115	85	14/10	10	76	23	14	4	F5
32	9410340032WZ 90	32	133	5.9	62	140	100	16/11	10	91	23	18	4	F5

ISO-flange acc. ISO5211.

# Monoblock and short valve - DN 15 - 32, PN 40/25/16

Type 94103 - Full bore



Technical drawing		Material description	
	1	Ball	Steel - SA351Gr CF8
	2	Valve body	Steel - S355J2C
	3	Seat ring	PTFE 20% Carbon
	4	Back-up ring	PTFE 20% Carbon
	5	O-ring	EPDM
	6	O-ring	FKM (Viton)
	8	ISO-flange	Steel - S355J2C

# Monoblock and short valve - DN 40 - 80, PN 16

## Type 94103 - Full bore

### Flange × Flange

Fully welded steel ball valve.

### Materials

See next page.

### Applications

Isolating valve for heating systems, district heating, cooling and industrial purpose.

### Media

Water and other media not decomposing the steel. If in doubt, please contact BROEN BALLOMAX® Sales Department.

### Surface treatment

Eco-friendly protection finish against corrosion.

### Operation

The standard handle is 180 degrees adjustable.

### Approvals and certificates

BROEN is certified according to ISO 9001 and environmentally certified according to ISO 14001. BROEN BALLOMAX® is approved according to the requirements of Pressure Equipment Directive (PED). All ball valves as from DN 40 are CE-marked. The 3.1 certificate is available upon request.

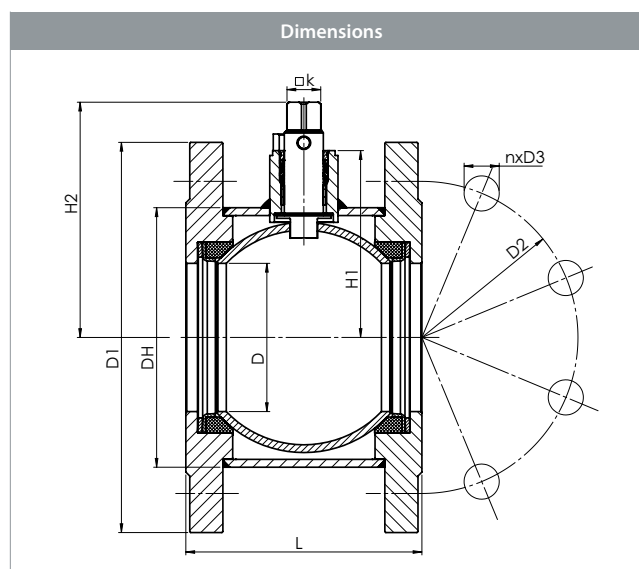

DN	BROEN No.	D = Bore	Kvs	net Weight kg	All dimensions in mm							D3	n
					L	DH	D1	D2	k	H1	H2		
40	9410316040WZ	39	229	4.3	77	76	150	110	11	70	87	18	4
50	9410316050WZ	49	295	5.6	86	89	165	125	11	77	94	18	4
65	9410316065WZ	63	498	7.6	106	114	185	145	14	88	113	18	8
80	9410316080WZ	76	754	9.2	121	133	200	160	14	96	121	18	8

# Monoblock and short valve - DN 40 - 80, PN 16

Type 94103 - Full bore

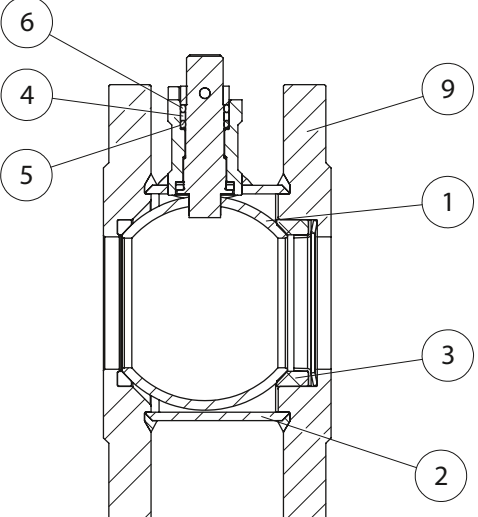

Technical drawing		Material description	
	1	Ball	Steel - SA351Gr CF8
	2	Valve body	Steel - S355J2C
	3	Seat ring	PTFE 20% Carbon
	4	Back-up ring	PTFE 20% Carbon
	5	O-ring	EPDM
	6	O-ring	FKM (Viton)
	9	Flange	Steel - S355J2C

# Monoblock and short valve - DN 40 - 80, PN 16

## Type 94103 - Full bore

### Flange × Flange

Fully welded steel ball valve.

### Materials

See next page.

### Applications

Isolating valve for heating systems, district heating, cooling and industrial purpose.

### Media

Water and other media not decomposing the steel. If in doubt, please contact BROEN BALLOMAX® Sales Department.

### Surface treatment

Eco-friendly protection finish against corrosion.

### Operation

The standard handle is 180 degrees adjustable.

### Approvals and certificates

BROEN is certified according to ISO 9001 and environmentally certified according to ISO 14001. BROEN BALLOMAX® is approved according to the requirements of Pressure Equipment Directive (PED). All ball valves as from DN 40 are CE-marked. The 3.1 certificate is available upon request.

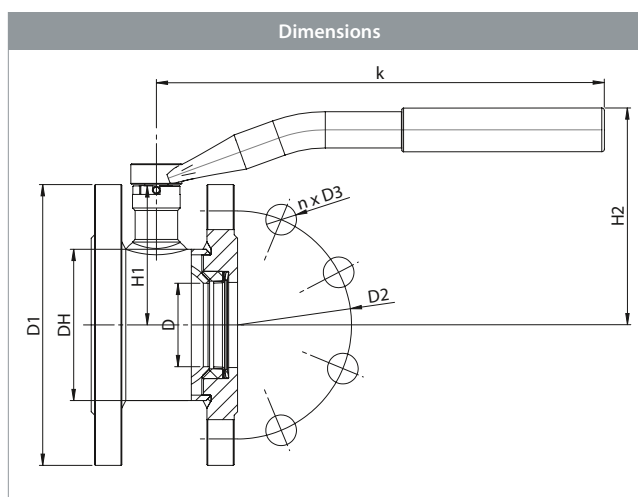

DN	BROEN No.	D = Bore	Kvs	net Weight kg	All dimensions in mm								D3	n
					L	DH	D1	D2	k	H1	H2			
40	9410316040WZ 01	39	229	4.5	77	76	150	110	177	70	127	18	4	
50	9410316050WZ 01	49	295	5.7	86	89	165	125	177	77	134	18	4	
65	9410316065WZ 01	63	498	8.0	106	114	185	145	190	88	158	18	8	
80	9410316080WZ 01	76	754	9.6	121	133	200	160	190	96	166	18	8	



# Monoblock and short valve - DN 40 - 80, PN 16

Type 94103 - Full bore



Technical drawing		Material description	
	1	Ball	Steel - SA351Gr CF8
	2	Valve body	Steel - S355J2C
	3	Seat ring	PTFE 20% Carbon
	4	Back-up ring	PTFE 20% Carbon
	5	O-ring	EPDM
	6	O-ring	FKM (Viton)
	7	Handle	Steel
	9	Flange	Steel - S355J2C

# Monoblock and short valve - DN 40 - 80, PN 16

## Type 94103 - Full bore

### Flange × Flange with ISO-flange

Fully welded steel ball valve.

### Materials

See next page.

### Applications

Isolating valve for heating systems, district heating, cooling and industrial purpose.

### Media

Water and other media not decomposing the steel. If in doubt, please contact BROEN BALLOMAX® Sales Department.

### Surface treatment

Eco-friendly protection finish against corrosion.

### Operation

The standard handle is 180 degrees adjustable.

### Approvals and certificates

BROEN is certified according to ISO 9001 and environmentally certified according to ISO 14001. BROEN BALLOMAX® is approved according to the requirements of Pressure Equipment Directive (PED). All ball valves as from DN 40 are CE-marked. The 3.1 certificate is available upon request.

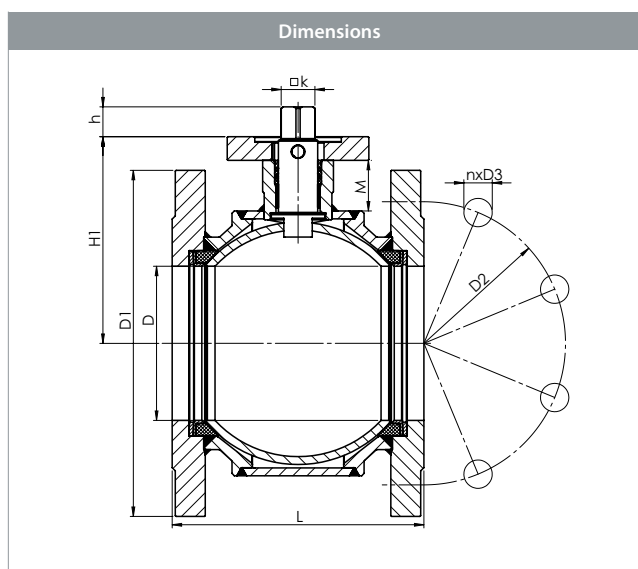

DN	BROEN No.	D = Bore	Kvs	net Weight kg	All dimensions in mm									
					L	D1	D2	k	h	H	M	D3	n	ISO
40	9410316040WZ 90	39	229	4.6	77	150	110	11	11.5	100	52	18	4	F5
50	9410316050WZ 90	49	295	5.9	86	165	125	11	11.5	108	53	18	4	F5
65	9410316065WZ 90	63	498	7.9	106	185	145	14	15.5	118	50	18	8	F5
80	9410316080WZ 90	76	754	9.5	121	200	160	14	15.5	125	49	18	8	F5

ISO-flange acc. ISO5211.

# Monoblock and short valve - DN 40 - 80, PN 16

Type 94103 - Full bore



Technical drawing		Material description	
	1	Ball	Steel - SA351Gr CF8
	2	Valve body	Steel - S355J2C
	3	Seat ring	PTFE 20% Carbon
	4	Back-up ring	PTFE 20% Carbon
	5	O-ring	EPDM
	6	O-ring	FKM (Viton)
	8	ISO-flange	Steel - S355J2C
	9	Flange	Steel - S355J2C

# Monoblock and short valve - DN 100 - 150, PN 16

## Type 94103 - Full bore

### Flange × Flange

Fully welded steel ball valve.

### Materials

See next page.

### Applications

Isolating valve for heating systems, district heating, cooling and industrial purpose.

### Media

Water and other media not decomposing the steel. If in doubt, please contact BROEN BALLOMAX® Sales Department.

### Surface treatment

Eco-friendly protection finish against corrosion.

### Operation

The standard handle is 180 degrees adjustable.

### Approvals and certificates

BROEN is certified according to ISO 9001 and environmentally certified according to ISO 14001. BROEN BALLOMAX® is approved according to the requirements of Pressure Equipment Directive (PED). All ball valves as from DN 40 are CE-marked. The 3.1 certificate is available upon request.

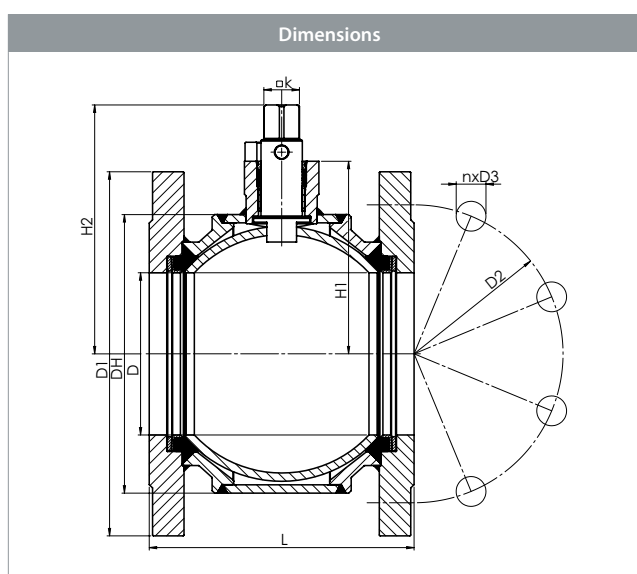

DN	BROEN No.	D = Bore	Kvs	net Weight kg	All dimensions in mm								
					L	DH	D1	D2	k	H1	H2	D3	n
100	9410316100WZ	98	1159	14.6	160	168.0	220	180	17	117.0	151.0	18	8
125	9410316125WZ	125	1841	22.6	186	219.0	250	210	17	147.0	183.0	18	8
150	9410316150WZ	150	2652	35.2	236	267.0	285	240	22	167.5	203.5	22	8

# Monoblock and short valve - DN 100 - 150, PN 16

Type 94103 - Full bore

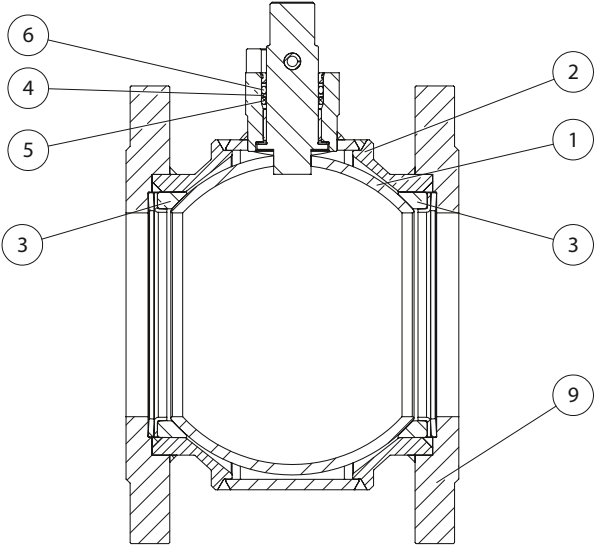

Technical drawing		Material description	
	1	Ball	Steel - SA351Gr CF8
	2	Valve body	Steel - S355J2C
	3	Seat ring	PTFE 20% Carbon
	4	Back-up ring	PTFE 20% Carbon
	5	O-ring	EPDM
	6	O-ring	FKM (Viton)
	9	Flange	Steel - S355J2C

# Monoblock and short valve - DN 100 - 150, PN 16

## Type 94103 - Full bore

### Flange × Flange

Fully welded steel ball valve.

### Materials

See next page.

### Applications

Isolating valve for heating systems, district heating, cooling and industrial purpose.

### Media

Water and other media not decomposing the steel. If in doubt, please contact BROEN BALLOMAX® Sales Department.

### Surface treatment

Eco-friendly protection finish against corrosion.

### Operation

The standard handle is 180 degrees adjustable.

### Approvals and certificates

BROEN is certified according to ISO 9001 and environmentally certified according to ISO 14001. BROEN BALLOMAX® is approved according to the requirements of Pressure Equipment Directive (PED). All ball valves as from DN 40 are CE-marked. The 3.1 certificate is available upon request.

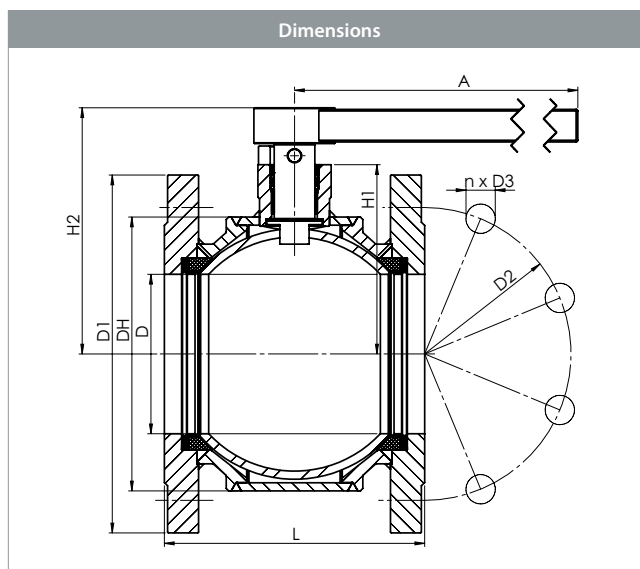

					All dimensions in mm								
DN	BROEN No.	D = Bore	Kvs	net Weight kg	L	DH	D1	D2	A	H1	H2	D3	n
100	9410316100WZ 01	98	1159	16.0	160	168.0	220	180	500	117	151	18	8
125	9410316125WZ 01	125	1841	24.1	186	219.0	250	210	500	147	183	18	8
150	9410316150WZ 01	150	2652	37.2	236	267.0	285	240	600	168	204	22	8

# Monoblock and short valve - DN 100 - 150, PN 16

Type 94103 - Full bore

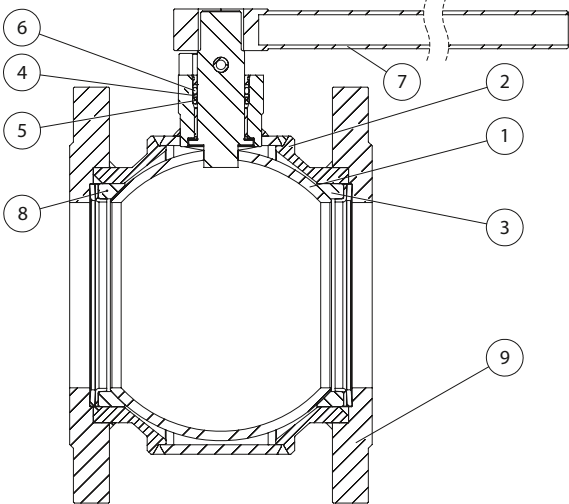

Technical drawing		Material description	
	1	Ball	Steel - SA351Gr CF8
	2	Valve body	Steel - S355J2C
	3	Seat ring	PTFE 20% Carbon
	4	Back-up ring	PTFE 20% Carbon
	5	O-ring	EPDM
	6	O-ring	FKM (Viton)
	7	Handle	Steel
	8	ISO-flange	Steel - S355J2C
	9	Flange	Steel - S355J2C

# Monoblock and short valve - DN 100 - 200, PN 16

## Type 94103 - Full bore

### Flange × Flange with ISO-flange

Fully welded steel ball valve.

### Materials

See next page.

### Applications

Isolating valve for heating systems, district heating, cooling and industrial purpose.

### Media

Water and other media not decomposing the steel. If in doubt, please contact BROEN BALLOMAX® Sales Department.

### Surface treatment

Eco-friendly protection finish against corrosion.

### Operation

The standard handle is 180 degrees adjustable.

### Approvals and certificates

BROEN is certified according to ISO 9001 and environmentally certified according to ISO 14001. BROEN BALLOMAX® is approved according to the requirements of Pressure Equipment Directive (PED). All ball valves as from DN 40 are CE-marked. The 3.1 certificate is available upon request.

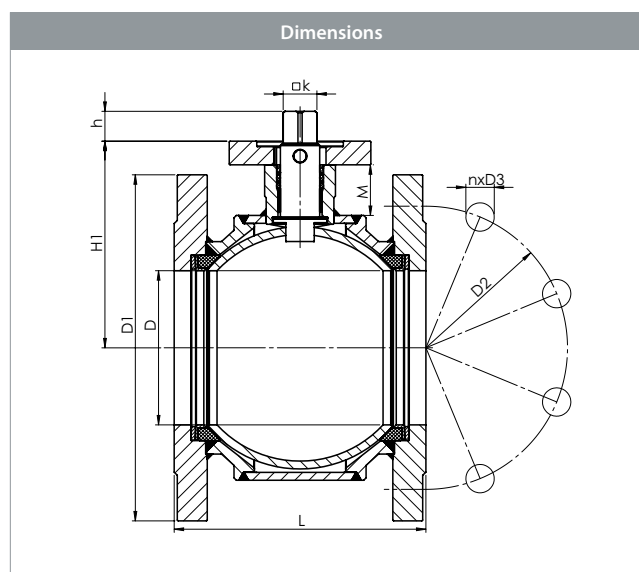

					All dimensions in mm									
DN	BROEN No.	D = Bore	Kvs	net Weight kg	L	D1	D2	k	h	H	M	D3	n	ISO
100	9410316100WZ 90	98	1159	15.0	160	220	180	17	22	128	34	18	8	F7
125	9410316125WZ 90	125	1841	24.4	186	270	220	17	20	163	39	18	8	F12
150	9410316150WZ 90	150	2652	36.9	236	285	240	22	21	203	35	22	8	F12
200	9410316200WZ 90	195	5720	93.5	292	340	295	22	21	237	40	22	12	F12

ISO-flange acc. ISO5211.



# Monoblock and short valve - DN 100 - 200, PN 16

Type 94103 - Full bore

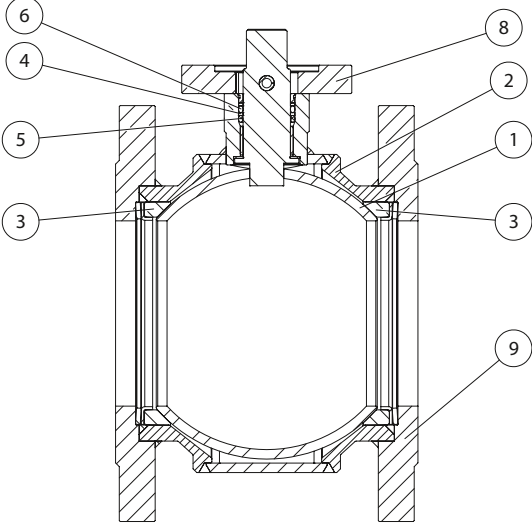

Technical drawing		Material description	
	1	Ball	Steel - SA351Gr CF8
	2	Valve body	Steel - S355J2C
	3	Seat ring	PTFE 20% Carbon
	4	Back-up ring	PTFE 20% Carbon
	5	O-ring	EPDM
	6	O-ring	FKM (Viton)
	8	ISO-flange	Steel - S355J2C
	9	Flange	Steel - S355J2C

# Monoblock and short valve - DN 100 - 200, PN 16

## Type 94103 - Full bore

### Flange × Flange with ISO-flange and BROEN-Gear

Fully welded steel ball valve.

### Materials

See next page.

### Applications

Isolating valve for heating systems, district heating, cooling and industrial purpose.

### Media

Water and other media not decomposing the steel. If in doubt, please contact BROEN BALLOMAX® Sales Department.

### Surface treatment

Eco-friendly protection finish against corrosion.

### Approvals and certificates

BROEN is certified according to ISO 9001 and environmentally certified according to ISO 14001. BROEN BALLOMAX® is approved according to the requirements of Pressure Equipment Directive (PED). All ball valves as from DN 40 are CE-marked. The 3.1 certificate is available upon request.

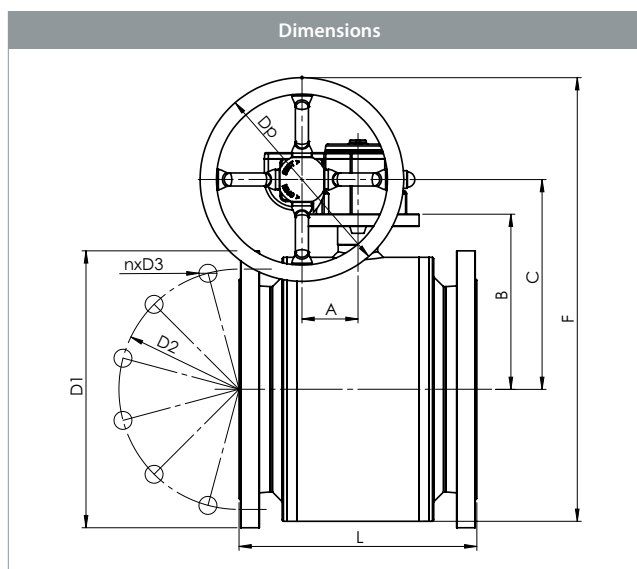

					All dimensions in mm										
DN	BROEN No.	D = Bore	Kvs	net Weight kg	L	D1	D2	DP	A	B	C	F	D3	n	ISO
100	9410316100WZ 99	98	1159	19.8	160	220	180	160	53	132	165	329	18	8	F7
125	9410316125WZ 99	125	1841	33.0	186	270	220	250	69	162	205	439	18	8	F12
150	9410316150WZ 99	150	2652	45.5	236	285	240	250	69	182	225	484	22	8	F12
200	9410316200WZ 99	195	5720	102.1	292	340	295	250	69	215	258	545	22	12	F12

Valve with gear is tested and prepared for use.

# Monoblock and short valve - DN 100 - 200, PN 16

Type 94103 - Full bore



Technical drawing		Material description	
	1	Ball	Steel - SA351Gr CF8
	2	Valve body	Steel - S355J2C
	3	Seat ring	PTFE 20% Carbon
	9	Flange	Steel - S355J2C
	10	BROEN gearbox	-

